

HENRICO COUNTY N.A.D.83

GLENN, THOMAS
ARTHUR
767-761-4200
DB.3829 PG.1235

LOT 27 & ADJ. TRIANGLE
MICHAEL A. WHEELER
& JENNIFER MADDOX
767-760-7067
DB.5561 PG.156

MAP OF
SECTION "B"
LAUREL HEIGHTS
PB.18 PG.32

LINE	BEARING	DISTANCE
L1	N 57°20'00" W	137.08'
L2	N 35°00'16" W	205.80'
L3	S 35°00'16" E	205.80'
L4	S 57°20'00" E	137.08'
L5	N 85°51'36" E	49.64'
L6	S 85°51'36" W	53.51'
L7	S 44°02'03" W	54.86'
L8	S 81°21'53" W	290.70'
L9	N 08°38'07" W	16.00'
L10	N 81°21'53" E	285.30'
L11	N 44°02'03" E	49.45'

N=3760812.71
E=11767559.40

N=3760254.04
E=11767883.27
C11

SLOPE & DRAINAGE
EASEMENT
DB.2712 PG.2083

N=3760170.01
E=11767829.46
C1

CURVE	DELTA	RADIUS	LENGTH	TANGENT	CHORD	CHORD BEARING
C1	0°08'52"	754.88'	1.95'	0.97'	1.95'	N 28°55'01" E
C2	86°19'27"	25.00'	37.67'	23.45'	34.20'	N 14°10'17" W
C3	22°19'44"	325.00'	126.66'	64.14'	125.86'	N 46°10'08" W
C4	5°49'48"	275.00'	27.98'	14.00'	27.97'	N 37°55'10" W
C5	47°21'10"	40.00'	33.06'	17.54'	32.13'	N 64°30'39" W
C6	267°21'55"	50.00'	233.32'	52.35'	72.32'	N 45°29'43" E
C7	41°19'14"	40.00'	28.85'	15.08'	28.23'	S 21°28'57" E
C8	7°08'18"	325.00'	40.49'	20.27'	40.46'	S 38°34'25" E
C9	22°19'44"	275.00'	107.17'	54.27'	106.49'	S 46°10'08" E
C10	86°19'27"	25.00'	37.67'	23.45'	34.20'	N 79°30'17" E
C11	0°04'46"	754.87'	1.05'	0.52'	1.05'	S 36°22'56" W
C12	7°34'44"	754.88'	99.85'	50.00'	99.78'	S 32°37'57" W
C13	7°21'06"	754.88'	96.86'	48.50'	96.79'	S 18°27'52" E

S79°13'18"E
15.93'

LAUREL PRESBYTERIAN
CHURCH OF GLEN ALLEN
767-760-2252
DB.49221 PG.291

LOT 8, PART OF 7 & 28
ALEKSANDROV,
ALEKSANDER & VELIZARA
767-760-6711
DB.5219 PG.642

LOT 6, PART OF 7 & 28
COALSON, BRIAN
HERBERT
767-760-5315
DB.2471 PG.64

MAP OF
SECTION "B"
LAUREL HEIGHTS
PB.18 PG.32

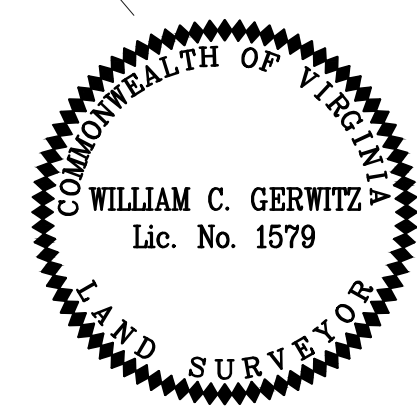

**LAUREL HEIGHTS
SECTION D**
A PORTION OF LOT 28 OF
AND A RESUBDIVISION OF
LAUREL HEIGHTS SECTION B
BROOKLAND DISTRICT HENRICO COUNTY, VIRGINIA

NOVEMBER 9, 2018 SHEET 2 OF 2 SCALE: 1"=60'

YOUNGBLOOD, TYLER & ASSOCIATES, P.C.
CIVIL ENGINEERS, PLANNERS
& LAND SURVEYORS
7309 HANOVER GREEN DRIVE
P.O. BOX 517 MECHANICSVILLE, Va. 23111

DRAWN BY: JMD
CHECKED BY: WCG

JOB No. 18238
CAD FILE: 18238-SUBPLAT

APPROVED BY THE
HENRICO COUNTY PLANNING COMMISSION
AND/OR DIRECTOR OF PLANNING

DATE _____ ACTING SECRETARY/AGENT _____

TIE DISTANCES ALONG CURVES ARE
SHOWN AS CHORD DISTANCES

(XX.XX') DENOTES AN EASEMENT TIE

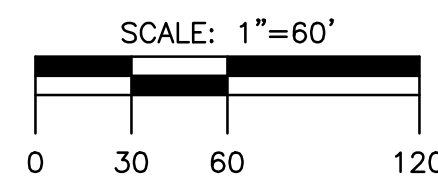

RECORDED DATE: _____ PB. _____ PG. _____